

Sales Code: PRC645CB

Description: 500X330 2In1 Combi Unit-Inc Basin & Cist

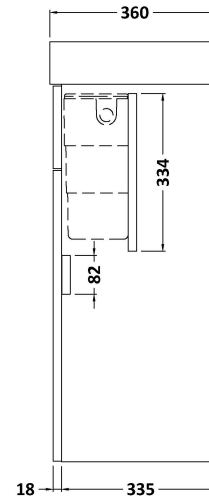
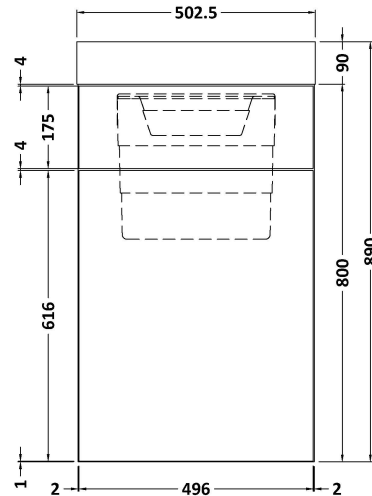
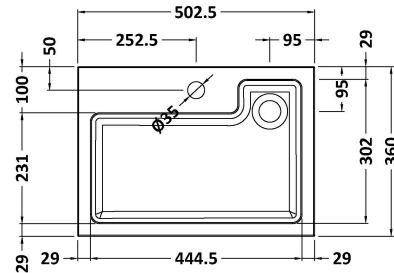

### Product Dimensions

Height (mm):	890
Width (mm):	503
Depth (mm):	360
Nett Weight (kg):	30.5

### Packaging Dimensions

Height (mm):	785
Width (mm):	525
Depth (mm):	370
Gross Weight (kg):	30.5

### Packaging Data

Box Colour:	Brown Cardboard Box
Box Qty:	1
Label Size:	100 x 50
Label Colour:	White Label
Label Qty:	2

### Outer Box Dimensions (If Applicable)

Height (mm):	
Width (mm):	
Depth (mm):	
Gross Weight (kg):	
Barcode:	5056211803836

### Product Details

Country of Origin:	United Kingdom
Fitting Instruction:	No
CE & UKCA:	Yes
FSC Certified Materials:	Yes
Colour:	Black Woodgrain
Construction Method:	Cam & Wood Dowel
Construction Type:	Rigid
Cabinet Finish:	MFC Textured Woodgrain
Fascia Finish:	MFC Textured Woodgrain
Cabinet Thickness (mm):	18
Fascia Thickness (mm):	18
Drawer Included:	No
Drawer Type:	Not Applicable
No of Shelves:	0
Hinge Type:	Not Applicable
Hinge Included:	No, Not Required
Adjustable Legs:	Not Applicable
Fixings Included:	No
Handle Style:	Not Applicable
Waste Shroud:	Not Applicable
Handle Included:	No, Not Required
Handle Type:	Not Applicable