

Sales Code: PRC545CB

Description: 500X330 2In1 Combi Unit-Inc Basin & Cist

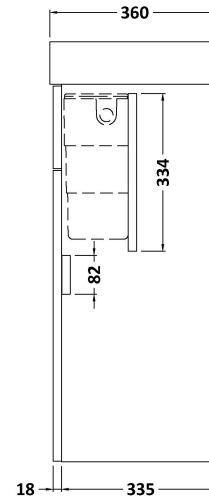
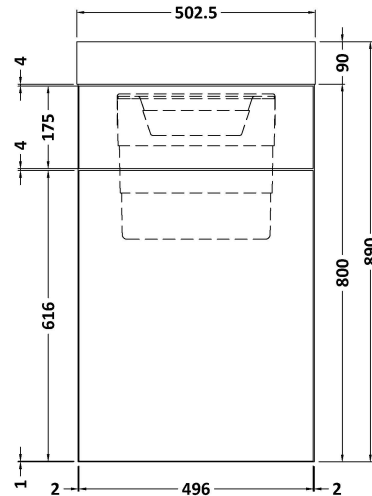
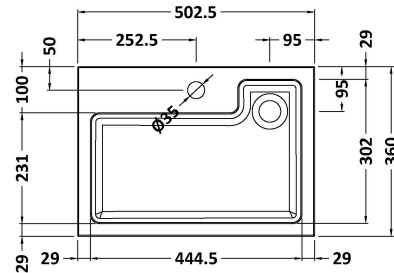

Product Dimensions

| | |
|-------------------|------|
| Height (mm): | 890 |
| Width (mm): | 503 |
| Depth (mm): | 360 |
| Nett Weight (kg): | 30.5 |

Packaging Dimensions

| | |
|--------------------|------|
| Height (mm): | 785 |
| Width (mm): | 525 |
| Depth (mm): | 370 |
| Gross Weight (kg): | 30.5 |

Packaging Data

| | |
|---------------|---------------------|
| Box Colour: | Brown Cardboard Box |
| Box Qty: | 1 |
| Label Size: | 100 x 50 |
| Label Colour: | White Label |
| Label Qty: | 2 |

Outer Box Dimensions (If Applicable)

| | |
|--------------------|---------------|
| Height (mm): | |
| Width (mm): | |
| Depth (mm): | |
| Gross Weight (kg): | |
| Barcode: | 5056211803850 |

Product Details

| | |
|--------------------------|------------------------|
| Country of Origin: | United Kingdom |
| Fitting Instruction: | No |
| CE & UKCA: | Yes |
| FSC Certified Materials: | Yes |
| Colour: | Anthracite Woodgrain |
| Construction Method: | Cam & Wood Dowel |
| Construction Type: | Rigid |
| Cabinet Finish: | MFC Textured Woodgrain |
| Fascia Finish: | MFC Textured Woodgrain |
| Cabinet Thickness (mm): | 18 |
| Fascia Thickness (mm): | 18 |
| Drawer Included: | No |
| Drawer Type: | Not Applicable |
| No of Shelves: | 0 |
| Hinge Type: | Not Applicable |
| Hinge Included: | No, Not Required |
| Adjustable Legs: | Not Applicable |
| Fixings Included: | No |
| Handle Style: | Not Applicable |
| Waste Shroud: | Not Applicable |
| Handle Included: | No, Not Required |
| Handle Type: | Not Applicable |