

Thank you for purchasing this HiB product.

Please read through these instructions carefully and refer back to them during installation to ensure that your product is fitted safely and that it retains its high quality finish.

Please retain this leaflet for future reference.

Installation

Before replacing the door, ensure the domestic electrical mains supply to which the cabinet is to be connected is turned off.

It is strongly recommended that the removal and replacement of the door is conducted by two people.

1. Gently remove the door from the carcass. This is done by one person holding the cabinet door and the second person gently pulling the tab at the back of each hinge, as per Fig. A.
2. The person holding the cabinet door should lift the door away from the cabinet carefully allowing the second person to disconnect the wire(s) connecting the door to the carcass through the hinge(s) joint.
3. **When the wire is disconnected ensure that they do not fall inside the cabinet carcass.**
4. Dispose of the broken cabinet door safely and unpackage the spare cabinet door.
5. Similar to disconnecting the door, one person holds the door slightly away from the cabinet to allow the second person to reconnect the door and carcass wire(s) together in the hinge(s) joint.
6. **Be sure to match the correct colour wires together**
7. When the wire(s) are correctly reconnected the person not holding the door can reconnect the hinge(s) back onto the cabinet carcass. **Push any excess wire back inside the cabinet before attaching the hinges.**
8. If it is necessary to realign the door(s) level, see figure Fig. B.

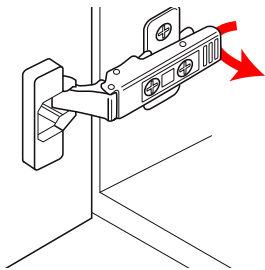

Door Removal (Fig. A)

After installation, it may be necessary to alter the alignment of the doors. The small screws on each hinge must be turned, which will move the door position.

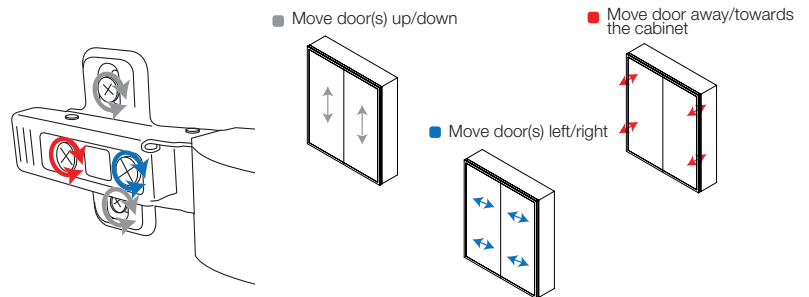

Hinge alignment (Fig. B)

Care Instructions

To preserve the high quality finish of your HiB product, please ensure you regard the following care and cleaning recommendations:

Do not use abrasives or solvents when cleaning this product.

Wipe off all water spillages as soon as possible using a soft cloth.

In the unlikely event that this product should fail please contact HiB customer services, contact detail shown below.



WEEE compliance

Must not be mixed with general household waste